

TRUMAN ST. 80'

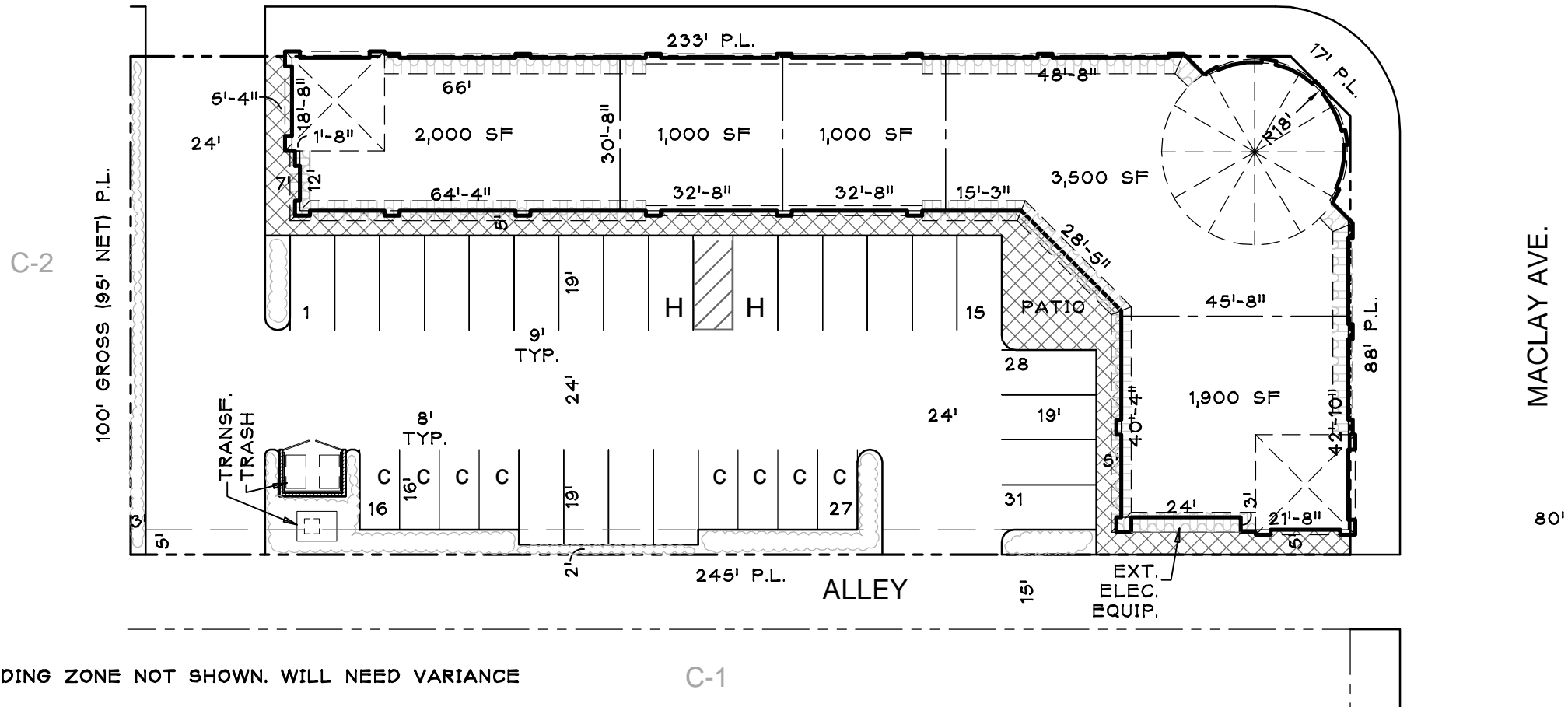

NOTE:  
- 14'X40' LOADING ZONE NOT SHOWN. WILL NEED VARIANCE

	GROSS	NET
BLDG. AREA:	9,510 SF	9,400 SF

	GROSS	NET
LAND AREA:	24,428 SF	23,250 SF

PARKING REQUIRED: 31 (1:300)  
COMPACT PARKING SPACES ALLOWED: NO MORE THAN 30% OF TOTAL REQUIRED PARKING

PARKING PROVIDED: 31 (23 STANDARD, 8 COMPACTS, 26% )

LANDSCAPING REQ'D.: 180 SF (NO LESS THAN 2% OF AREA DEVOTED TO PARKING.)

LANDSC. PROVIDED: 347 SF

ZONE / COMM. PLAN: C-2

GENERAL PLAN:

CITY OF SAN FERNANDO, CALIFORNIA

PROJECTS \ TRUMAN & MACLAY

**SCHEME 2.0M**  
10/30/08 DB/AG

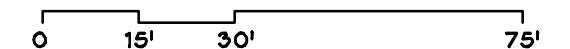

**T. W. LAYMAN ASSOCIATES**  
PRE-PRELIMINARY SITE PLAN

NOT REVIEWED WITH GOVERNMENTAL AGENCIES.  
TWLA SITE VISIT PENDING.  
SURVEY PENDING.

**PORTER DEVELOPMENT CO.**